

ANALOG OUTPUT FOR DISTANCE CONTROL



ANALOG OUTPUT

INDUCTIVE SENSORS

KEY ADVANTAGES

- ✓ Highest sensing ranges
- ✓ Best temperature stability
- ✓ Excellent repeat accuracy
- ✓ Resolution in μm range

RANGE OVERVIEW	Housing size	Extra Distance
ANALOG	C8	p. 113
	M8	p. 113-114
	M12	p. 114-115
	M18	p. 115-116
	M30	p. 116-117

FAMILY

HOUSING SIZE MM

SENSING RANGE MM

INDUCTIVE

WIRING DIAGRAMS

Analog C8/M8

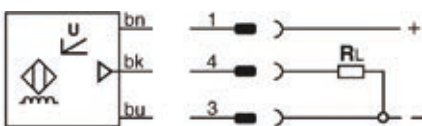

Analog M12/M18/M30

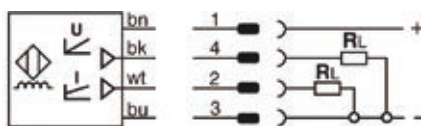

DATA

Bandwidth (-3 dB)
Output voltage
Housing material
Connection
Degree of protection
Mounting
Supply voltage range
Ambient temperature range
Output current
Description
Part reference
Description
Part reference
Description
Part reference
Other types available

ANALOG OUTPUT

EXTRA DISTANCE	EXTRA DISTANCE	EXTRA DISTANCE	EXTRA DISTANCE
□ 8 x 8	□ 8 x 8	M8	M8
0 ... 4	0 ... 4	0 ... 4	0 ... 4

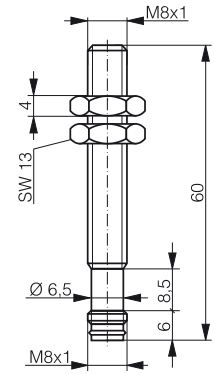
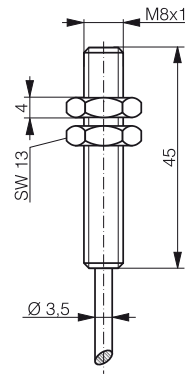
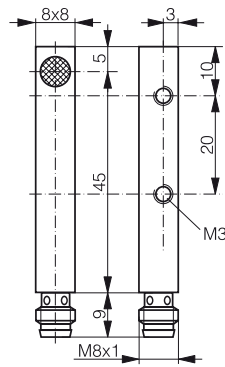
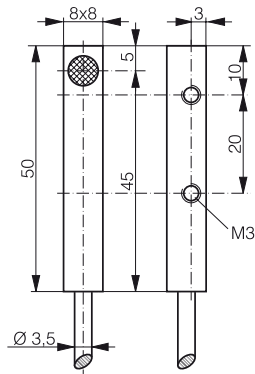





1,600 Hz (at s = 2 mm)	1,600 Hz (at s = 2 mm)	1,600 Hz (at s = 2 mm)	1,600 Hz (at s = 2 mm)
0 ... 10 V	0 ... 10 V	0 ... 5 V / 0 ... 10 V (-390)	0 ... 10 V
Chrome-plated brass	Chrome-plated brass	Chrome-plated brass	Chrome-plated brass
PUR cable	Connector S8	PUR cable	Connector S8
IP 67	IP 67	IP 67	IP 67
Quasi-embeddable	Quasi-embeddable	Quasi-embeddable	Quasi-embeddable
15 ... 30 VDC	15 ... 30 VDC	10 ... 30 VDC / 15 ... 30 VDC (-390)	15 ... 30 VDC
-25 ... +70 °C / -13 ... +158 °F	-25 ... +70 °C / -13 ... +158 °F	-25 ... +70 °C / -13 ... +158 °F	-25 ... +70 °C / -13 ... +158 °F
-	-	-	-
Output 0...10 V	Output 0...10 V	Output 0...5 V	Output 0...10 V
DW-AD-509-C8-390	DW-AS-509-C8-390	DW-AD-509-M8	DW-AS-509-M8-390
		Output 0...10 V	
		DW-AD-509-M8-390	
-	-	-	On request

ANALOG OUTPUT

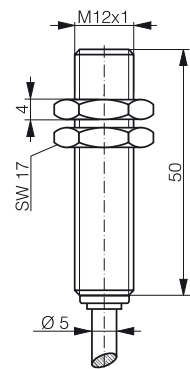
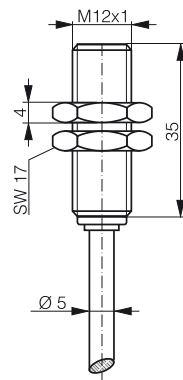
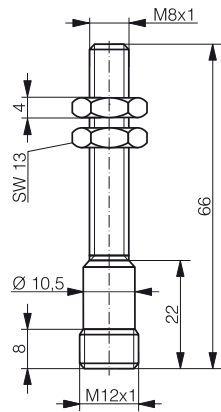
INDUCTIVE

FAMILY	EXTRA DISTANCE	EXTRA DISTANCE	EXTRA DISTANCE
HOUSING SIZE	M8	M12	M12
SENSING RANGE MM	0 ... 4	0 ... 6	0 ... 6



DATA			
Bandwidth (-3 dB)	1,600 Hz (at s = 2 mm)	1,000 Hz (at s = 3 mm)	1,000 Hz (at s = 3 mm)
Output voltage	0 ... 10 V	0 ... 5 V / 0 ... 10 V (-390)	0 ... 5 V / 0 ... 10 V (-390)
Housing material	Chrome-plated brass	Chrome-plated brass	Chrome-plated brass
Connection	Connector S12	PUR cable	PUR cable
Degree of protection	IP 67	IP 67	IP 67
Mounting	Quasi-embeddable	Quasi-embeddable	Quasi-embeddable
Supply voltage range	15 ... 30 VDC	10 ... 30 / 15 ... 30 VDC (-320)	10 ... 30 / 15 ... 30 VDC (-390)
Ambient temperature range	-25 ... +70 °C / -13 ... +158 °F	-25 ... +70 °C / -13 ... +158 °F	-25 ... +70 °C / -13 ... +158 °F
Output current	-	1 ... 5 mA (-120 only)	1 ... 5 mA / 4 ... 20 mA (-390)
Description	Output 0...10 V	Outputs 0...5 V / 1...5 mA	Outputs 0...5 V / 1...5 mA
Part reference	DW-AS-509-M8-393	DW-AD-509-M12-120	DW-AD-509-M12
Description		Output 0...10 V	Outputs 0...10 V / 4...20 mA
Part reference		DW-AD-509-M12-320	DW-AD-509-M12-390
Description			
Part reference			
Other types available	On request	-	-

ANALOG OUTPUT

EXTRA DISTANCE	EXTRA DISTANCE	EXTRA DISTANCE	EXTRA DISTANCE
M12	M12	M18	M18
0 ... 6	0 ... 6	0 ... 10	0 ... 10

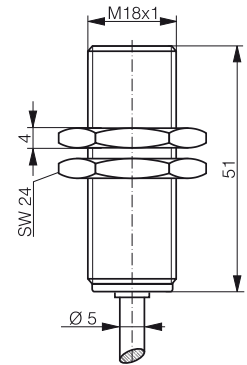
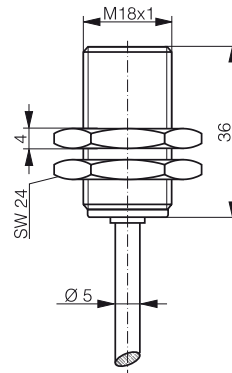
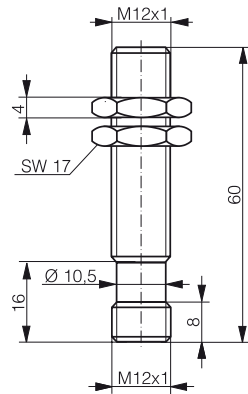
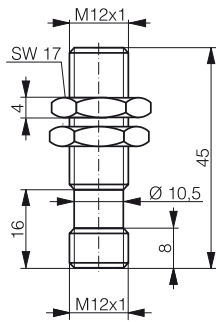





1,000 Hz (at s = 3 mm)	1,000 Hz (at s = 3 mm)	500 Hz (at s = 5 mm)	500 Hz (at s = 5 mm)
0 ... 5 V / 0 ... 10 V (-320)	0 ... 5 V / 0 ... 10 V (-390)	0 ... 5 V / 0 ... 10 V (-320)	0 ... 10 V
Chrome-plated brass	Chrome-plated brass	Chrome-plated brass	Chrome-plated brass
Connector S12	Connector S12	PUR cable	PUR cable
IP 67	IP 67	IP 67	IP 67
Quasi-embeddable	Quasi-embeddable	Quasi-embeddable	Quasi-embeddable
10 ... 30 / 15 ... 30 VDC (-320)	10 ... 30 / 15 ... 30 VDC (-390)	10 ... 30 / 15 ... 30 VDC (-320)	15 ... 30 VDC
-25 ... +70 °C / -13 ... +158 °F	-25 ... +70 °C / -13 ... +158 °F	-25 ... +70 °C / -13 ... +158 °F	-25 ... +70 °C / -13 ... +158 °F
1 ... 5 mA (-120 only)	1 ... 5 mA / 4 ... 20 mA (-390)	1 ... 5 mA / 4 ... 20 mA (-320)	4 ... 20 mA
Outputs 0...5 V / 1...5 mA	Outputs 0...5 V / 1...5 mA	Outputs 0...5 V / 1...5 mA	Outputs 0...10 V / 4...20 mA
DW-AS-509-M12-120	DW-AS-509-M12	DW-AD-509-M18-120	DW-AD-509-M18-390
Output 0...10 V	Outputs 0...10 V / 4...20 mA	Outputs 0...10 V / 4...20 mA	
DW-AS-509-M12-320	DW-AS-509-M12-390	DW-AD-509-M18-320	
-	-	-	On request

ANALOG OUTPUT

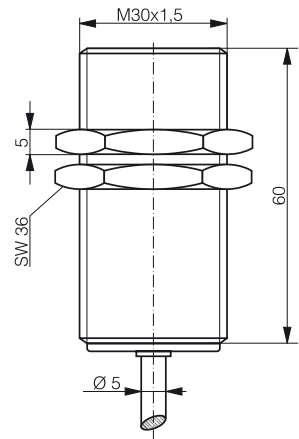
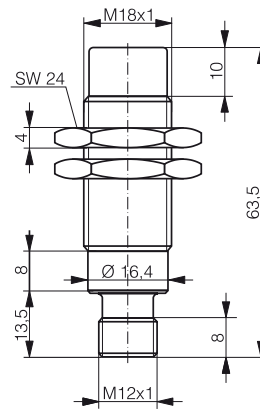
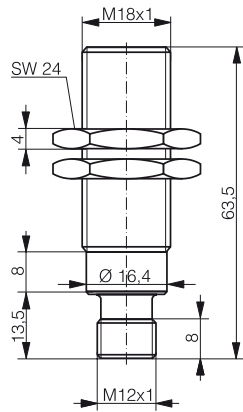
INDUCTIVE

FAMILY	EXTRA DISTANCE	EXTRA DISTANCE	EXTRA DISTANCE
HOUSING SIZE	M18	M18	M30
SENSING RANGE MM	0 ... 10	0 ... 20	0 ... 20



DATA			
Bandwidth (-3 dB)	500 Hz (at s = 5 mm)	250 Hz (at s = 10 mm)	200 Hz (at s = 10 mm)
Output voltage	0 ... 10 V	0 ... 5 V	0 ... 10 V
Housing material	Chrome-plated brass	Chrome-plated brass	Chrome-plated brass
Connection	Connector S12	Connector S12	PUR cable
Degree of protection	IP 67	IP 67	IP 67
Mounting	Quasi-embeddable	Non-embeddable	Quasi-embeddable
Supply voltage range	15 ... 30 VDC	10 ... 30 VDC	15 ... 30 VDC
Ambient temperature range	-25 ... +70 °C / -13 ... +158 °F	-25 ... +70 °C / -13 ... +158 °F	-25 ... +70 °C / -13 ... +158 °F
Output current	4 ... 20 mA	1 ... 5 mA	4 ... 20 mA
Description	Outputs 0...10 V / 4...20 mA	Outputs 0...5 V / 1...5 mA	Outputs 0...10 V / 4...20 mA
Part reference	DW-AS-509-M18-390	DW-AS-519-M18-002	DW-AD-509-M30-390
Description			
Part reference			
Description			
Part reference			
Other types available	On request	On request	On request

ANALOG OUTPUT

EXTRA DISTANCE	EXTRA DISTANCE	EXTRA DISTANCE	EXTRA DISTANCE
M30	M30	M30	M30
0 ... 20	0 ... 40	0 ... 40	0 ... 40

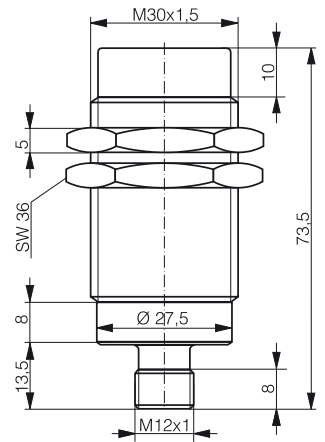
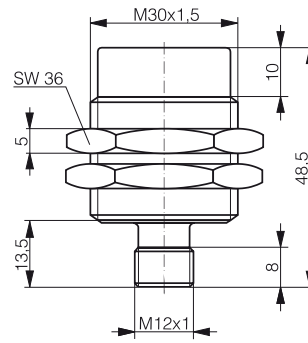
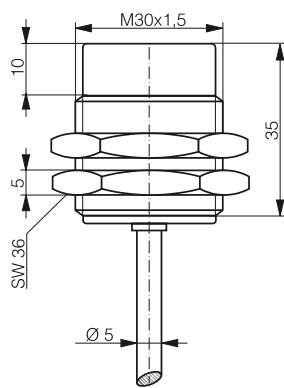
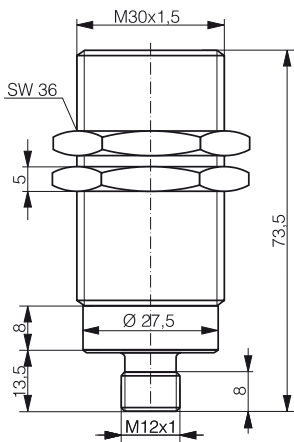

200 Hz (at s = 10 mm)	100 Hz (at s = 20 mm)	100 Hz (at s = 20 mm)	100 Hz (at s = 20 mm)
0 ... 10 V	0 ... 10 V	0 ... 10 V	0 ... 10 V
Chrome-plated brass	Chrome-plated brass	Chrome-plated brass	Chrome-plated brass
Connector S12	PUR cable	Connector S12	Connector S12
IP 67	IP 67	IP 67	IP 67
Quasi-embeddable	Non-embeddable	Non-embeddable	Non-embeddable
15 ... 30 VDC	15 ... 30 VDC	15 ... 30 VDC	15 ... 30 VDC
-25 ... +70 °C / -13 ... +158 °F	-25 ... +70 °C / -13 ... +158 °F	-25 ... +70 °C / -13 ... +158 °F	-25 ... +70 °C / -13 ... +158 °F
4 ... 20 mA	4 ... 20 mA	4 ... 20 mA	4 ... 20 mA
Outputs 0...10 V / 4...20 mA	Outputs 0...10 V / 4...20 mA	Outputs 0...10 V / 4...20 mA	Outputs 0...10 V / 4...20 mA
DW-AS-509-M30-390	DW-AD-519-M30-320	DW-AS-519-M30-320	DW-AS-519-M30-390
On request	On request	On request	On request